

PART NUMBER: 1473-N

TITLE:

**5kW VHF 4 POLES BAND PASS FILTER
CROSS COUPLING**

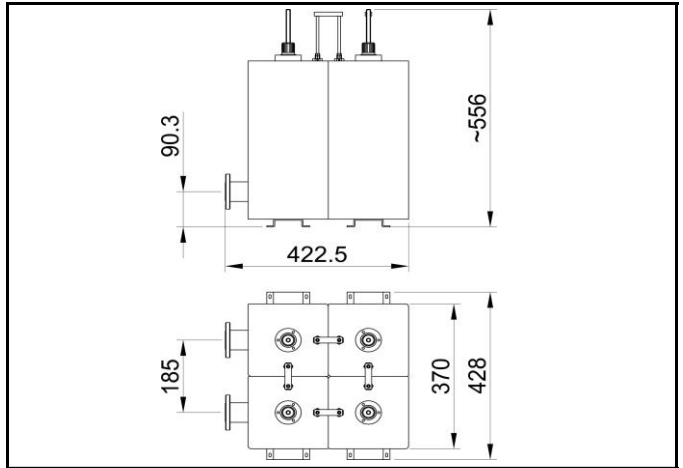

Tunable within whole VHF range.
For 6,7,8 MHz channel bandwidth.
DC block.
Different connectors on request.

Connectors: EIA 1 5/8"
Temperature range (C°): -10 ÷ 50
Weight (kg): 20

ATV (@ 8 MHz) STANDARD G,K	
Frequency range (MHz)	170 ÷ 230
Bandwidth (MHz)	8
Maximum output power (W)	5000
Insertion loss (dB) @ V.C.	< 0.2
Maximum amplitude variation (dB)	0.05
Atten. @ V.C. -5.5 and V.C. +11 MHz	> 30
Return loss (dB)	> 26
Input/output impedance (Ohm)	50
Maximum group delay variation (ns)	10

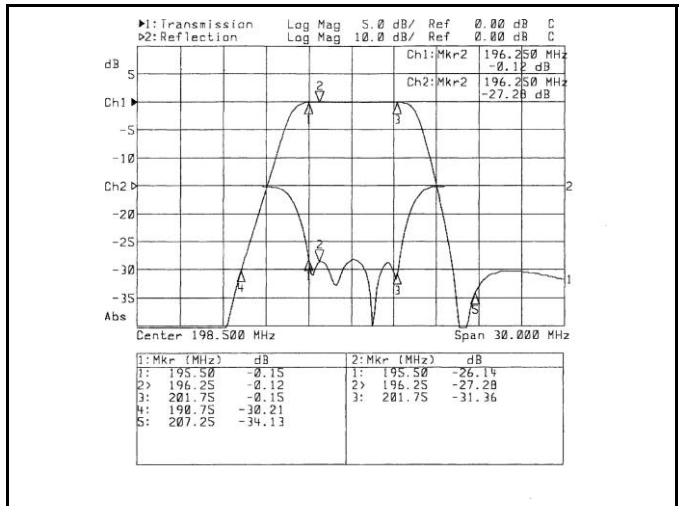

ATV (@ 6 MHz) STANDARD M,N	
Frequency range (MHz)	170 ÷ 230
Bandwidth (MHz)	6
Maximum output power (W)	5000
Insertion loss (dB) @ V.C.	< 0.2
Maximum amplitude variation (dB)	> 30
Atten. @ V.C. -4.5 and V.C. +9 MHz	> 30
Return loss (dB)	> 26
Input/output impedance (Ohm)	50
Maximum group delay variation (ns)	10